

HEAD WALL FLASHING (HW1)

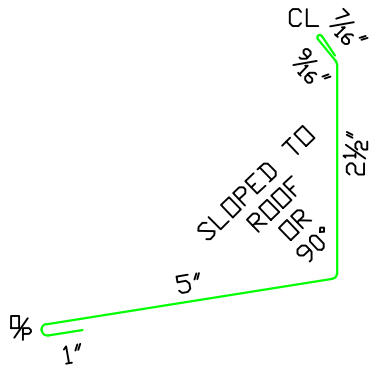

SLOPED TO
ROOF
OR
90°

ZEE CLOSURE (ZC1)

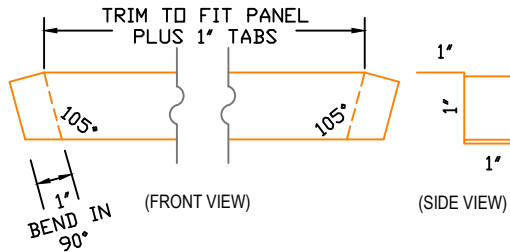

ROLLFAB METAL PRODUCTS
NS-10 STANDING SEAM
ROOFING PANEL

#44 x 1/8" BLIND PAINTED
RIVETS APPLIED @ 6" O.C.

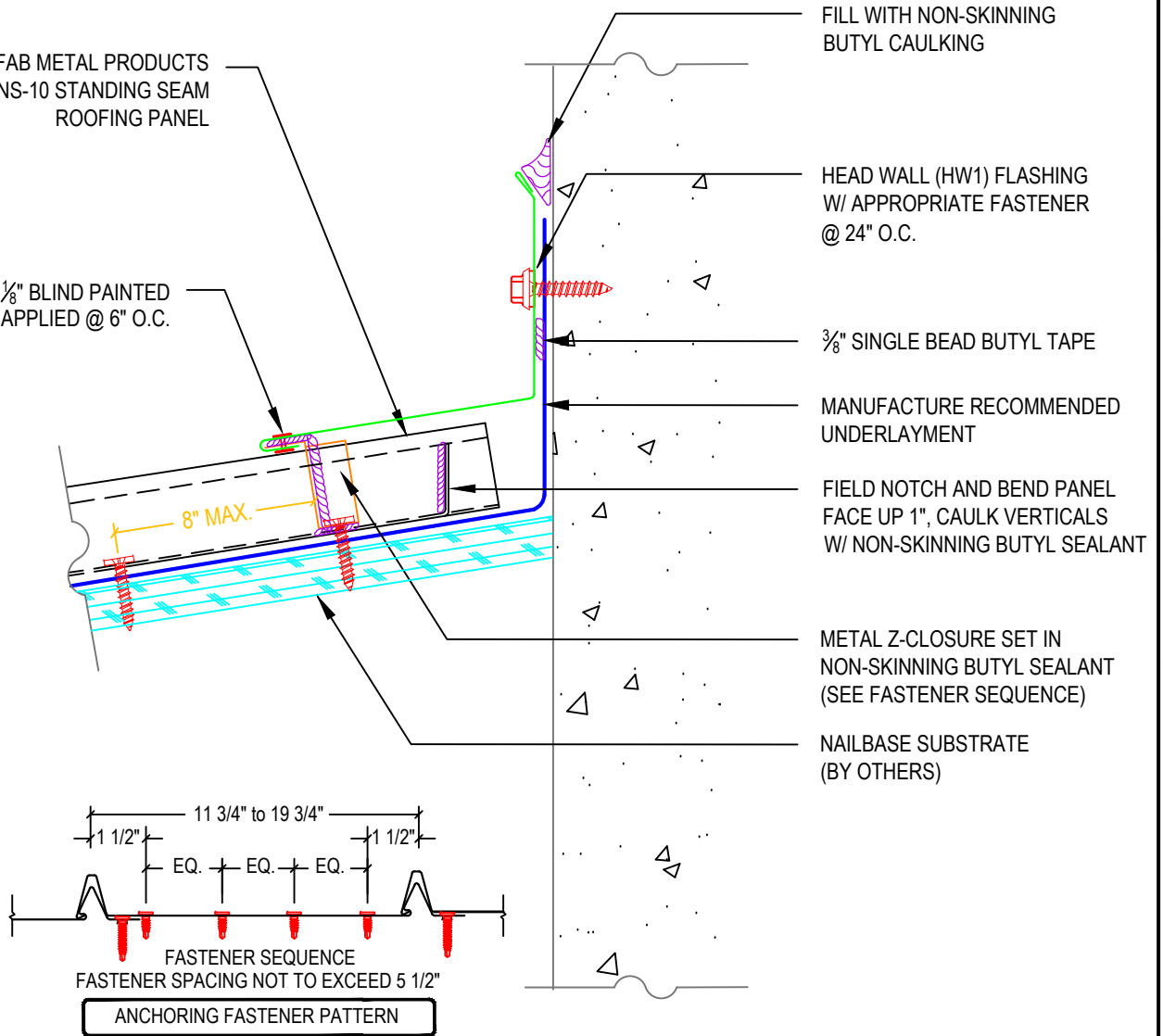

FILL WITH NON-SKINNING
BUTYL CAULKING

HEAD WALL (HW1) FLASHING
W/ APPROPRIATE FASTENER
@ 24" O.C.

3/8" SINGLE BEAD BUTYL TAPE

MANUFACTURE RECOMMENDED
UNDERLAYMENT

FIELD NOTCH AND BEND PANEL
FACE UP 1", CAULK VERTICALS
W/ NON-SKINNING BUTYL SEALANT

METAL Z-CLOSURE SET IN
NON-SKINNING BUTYL SEALANT
(SEE FASTENER SEQUENCE)

NAILBASE SUBSTRATE
(BY OTHERS)

FASTENER SEQUENCE
FASTENER SPACING NOT TO EXCEED 5 1/2"

ANCHORING FASTENER PATTERN

RMP
ROLLFAB
METAL PRODUCTS
www.rollfabmetal.com

HEAD WALL

2529 WEST JACKSON ST, PHX, AZ 85009
PH: (602) 275-1676 FAX: (602) 275-1739

PANEL SYSTEM: NS-10

ISSUE / REVISION
DATE:
1/28/2013

DETAIL NO.
NS10HW

NOT TO SCALE