

- #44 x 1/8" BLIND PAINTED RIVETS APPLIED @ 6" O.C.
- ROLLFAB METAL PRODUCTS MS-150 MECHANICAL SEAM ROOFING PANEL
- ROLLFAB METAL PRODUCTS MS-150 LOW-FLOATING ROOF PANEL CLIPS
- NAILBASE ROOF SUBSTRATE (BY OTHERS)
- INSULATION (OPT.) (BY OTHERS)
- METAL DECKING (OPT.) (BY OTHERS)

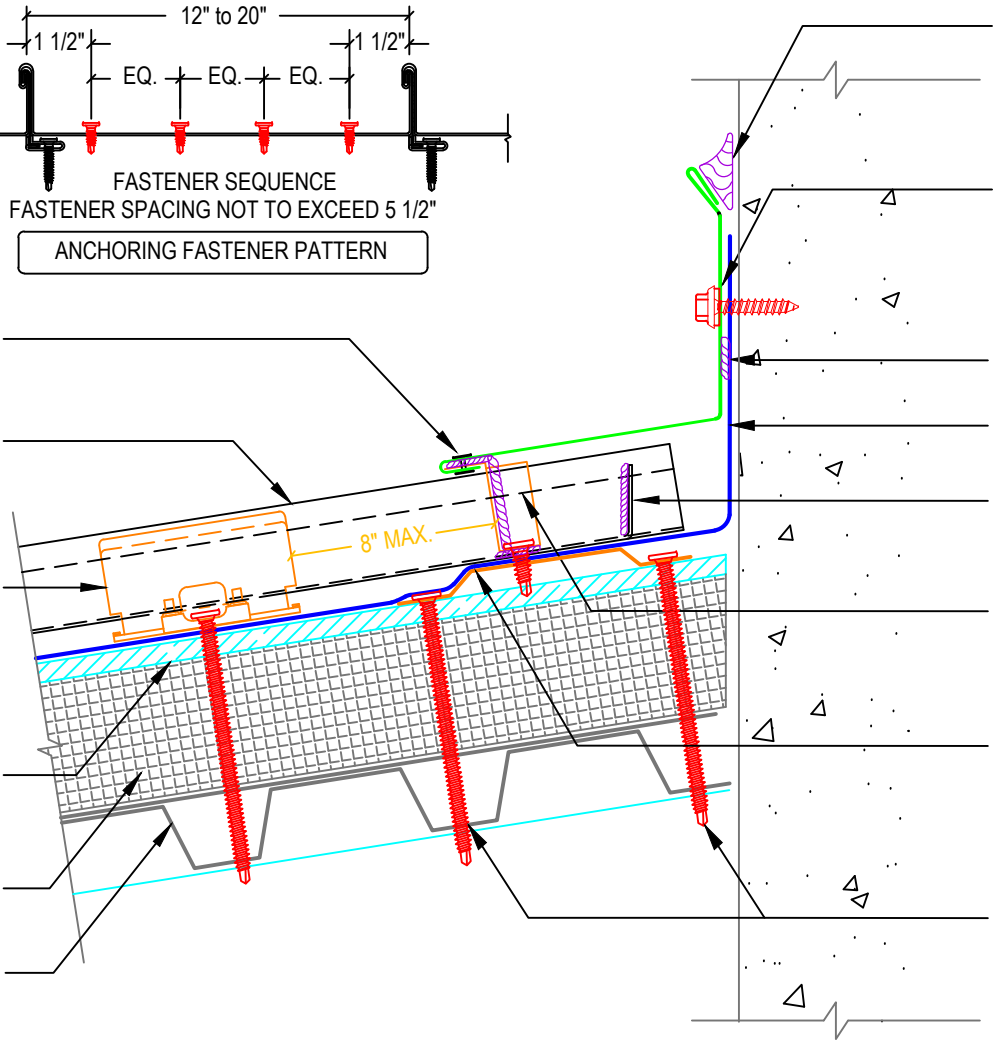

- FILL WITH NON-SKINNING BUTYL CAULKING
- HEAD WALL FLASHING W/ APPROPRIATE FASTENER @ 24" O.C.
- 3/8" SINGLE BEAD BUTYL TAPE
- RMP SA-HT SELF-ADHERED UNDERLAYMENT
- FIELD NOTCH AND BEND PANEL FACE UP 1 1/2" MIN., CAULK VERTICALS W/ NON-SKINNING BUTYL SEALANT
- METAL Z-CLOSURE SET IN NON-SKINNING BUTYL SEALANT (SEE FASTENER SEQUENCE)
- 20GA MIN. HAT CHANNEL SUPPORT
- APPROPRIATE FASTENER STAGGERED @ 24" O.C.



HEAD WALL

2529 WEST JACKSON ST, PHX, AZ 85009
 PH: (602) 275-1676 FAX: (602) 275-1739

PANEL SYSTEM: MS-150	
ISSUE / REVISION DATE: 1/28/2013	DETAIL NO. MS150-HW
NOT TO SCALE	