

SILL FLASHING

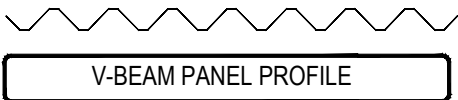

**\*\*IT IS RECOMMENDED, THAT A MANUFACTURE APPROVED "AIR & WATER/VAPOR" MEMBRANE BE APPLIED TO THE WALL, BEHIND THE WALL PANEL SYSTEM.**

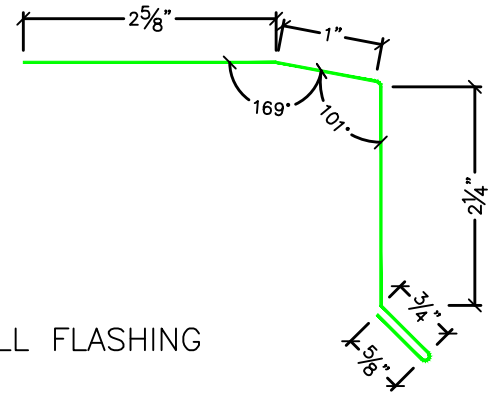
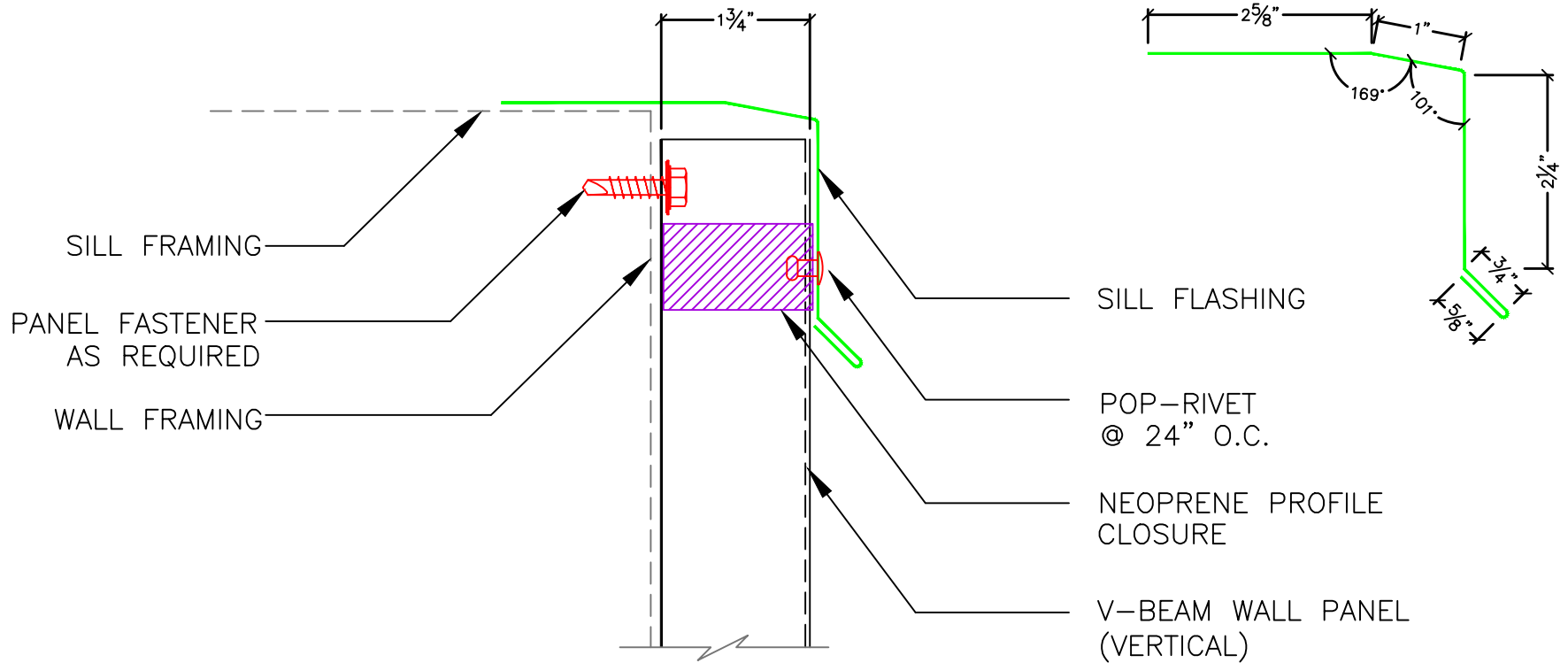

**VERTICAL SILL FLASHING**

2529 WEST JACKSON ST, PHX, AZ 85009  
 PH: (602) 275-1676 FAX: (602) 275-1739

PANEL SYSTEM: <b>V-BEAM</b>	
ISSUE / REVISION DATE: 04/30/14	DETAIL NO. <b>VBVSF</b>
NOT TO SCALE	