

RAKEWALL CLEAT (RW/C1)

#44 x $\frac{1}{8}$ " BLIND PAINTED RIVETS APPLIED @ 6" O.C.

ROLLFAB METAL PRODUCTS NS-10 STANDING SEAM ROOFING PANEL

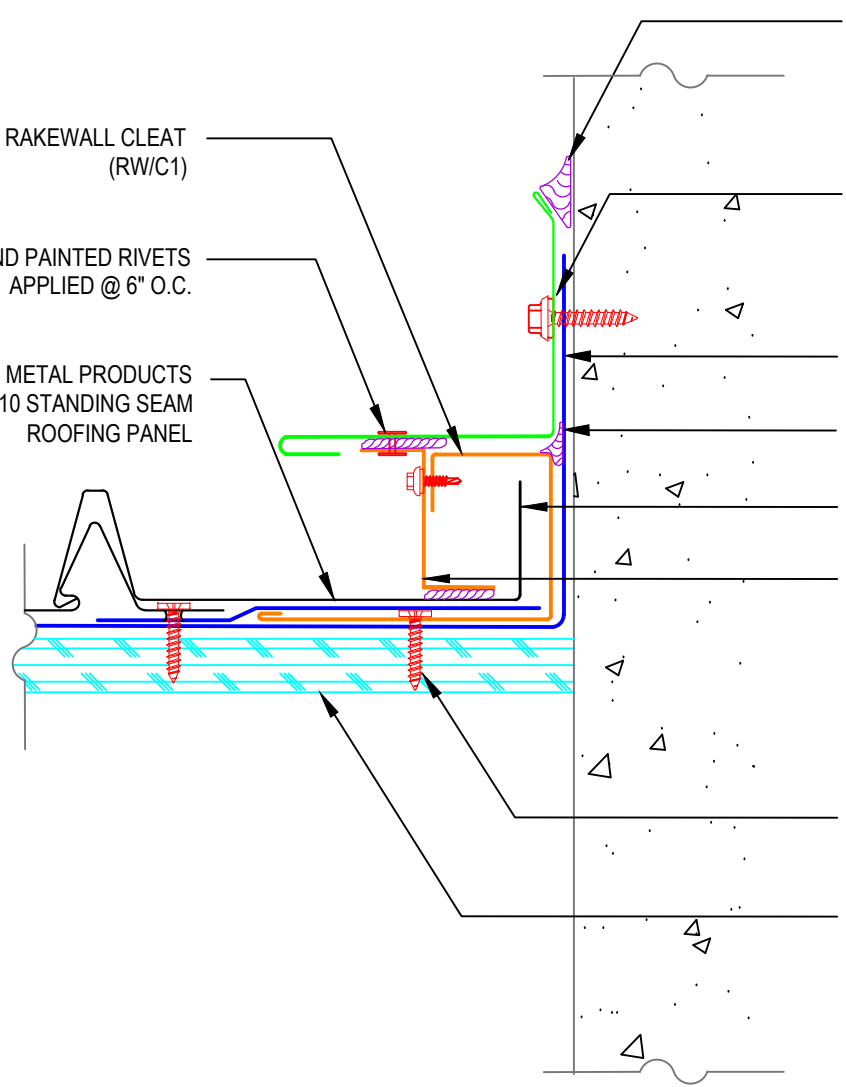

FILL WITH NON-SKINNING BUTYL CAULKING

RAKEWALL (RW1) FLASHING W/ APPROPRIATE FASTENER @ 24" O.C.

MANUFACTURE RECOMMENDED UNDERLAYMENT

FILL VOID W/ BEAD BUTYL CAULKING

FIELD CUT AND BEND PANEL FACE UP 1"

METAL Z-CLOSURE (ZC120) SET IN NON-SKINNING BUTYL SEALANT, ATTACH TO RAKE CLEAT WITH $\frac{1}{4}$ " - 14 x $\frac{7}{8}$ " STITCH W/ NEO WASHER

APPROPRIATE FASTENER @ 12" O.C. STAGGERED

NAILBASE SUBSTRATE (BY OTHERS)



OFF MODULE RAKEWALL W/ ZEE

2529 WEST JACKSON ST, PHX, AZ 85009
PH: (602) 275-1676 FAX: (602) 275-1739

PANEL SYSTEM: NS-10		DETAIL NO. NS10RWZ
ISSUE / REVISION DATE:	1/28/2013	
NOT TO SCALE		