

BOX RAKEWALL FLASHING (BRW1)

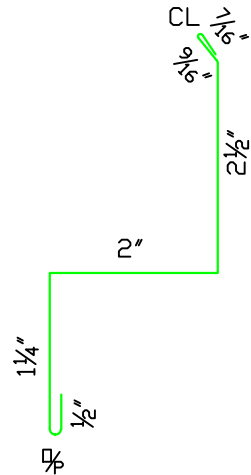

BOX RAKEWALL CLEAT (BRW/C1)

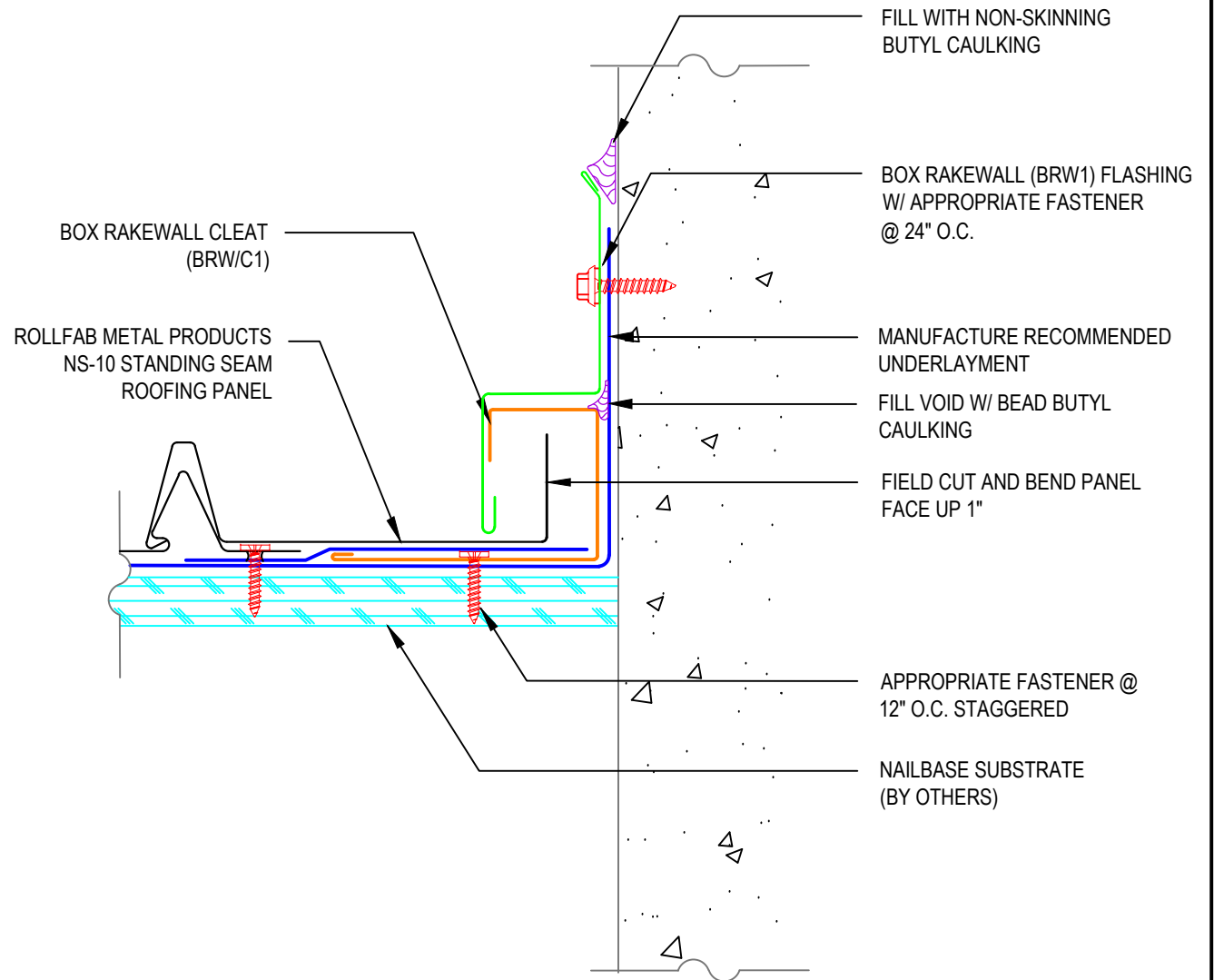
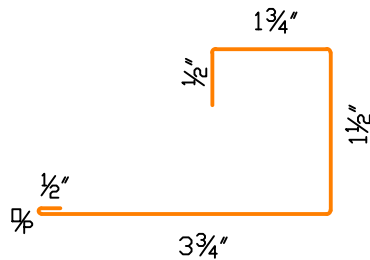

FILL WITH NON-SKINNING BUTYL CAULKING

BOX RAKEWALL (BRW1) FLASHING W/ APPROPRIATE FASTENER @ 24" O.C.

MANUFACTURE RECOMMENDED UNDERLAYMENT

FILL VOID W/ BEAD BUTYL CAULKING

FIELD CUT AND BEND PANEL FACE UP 1"

APPROPRIATE FASTENER @ 12" O.C. STAGGERED

NAILBASE SUBSTRATE (BY OTHERS)



**OFF MODULE BOX RAKEWALL**

2529 WEST JACKSON ST, PHX, AZ 85009  
 PH: (602) 275-1676 FAX: (602) 275-1739

PANEL SYSTEM: NS-10		DETAIL NO. <b>NS10BRW</b>
ISSUE / REVISION DATE: 1/28/2013		
NOT TO SCALE		